

INSTRUCTION SHEET FOR THE PANIC EXIT DEVICES SERIES 59015

WARNING: The characteristics of this product are essentially important for people's safety. No product changes different from those described in these instructions should be introduced (for the purpose of its compliance with EN1125). This product should be installed on hinged doors with a maximum mass of 200 kg, a maximum height of 2500mm and a maximum width of 1300mm, This item is non-handed (fig. 1) and may therefore be fitted on both left and right-handed doors. The figures in these instruction sheet refer to a panic exit device installed on a left hand Inward opening door, type "2", This panic exit device is to be installed together with the additional locking devices:

- 07036-60-0 pair of upper/lower latch-bolts (Fig. 1-A)
- 07063-50-0 pair of front latch-bolts (Fig. 1-B)
- 07063-70-0 pair of upper/lower deadbolts (Fig. 1-C)
- 07063-65-1/2 pair of upper and lower front latch-bolts (Fig. 1-D)
- 07063-25-1/2 front latch-bolt for additional locking device (Fig. 1-E)

It should be installed together with the bar 07007-13/14/60/61-0.

Note: *Maintenance data sheet* and *Statements of Compliance* attached.

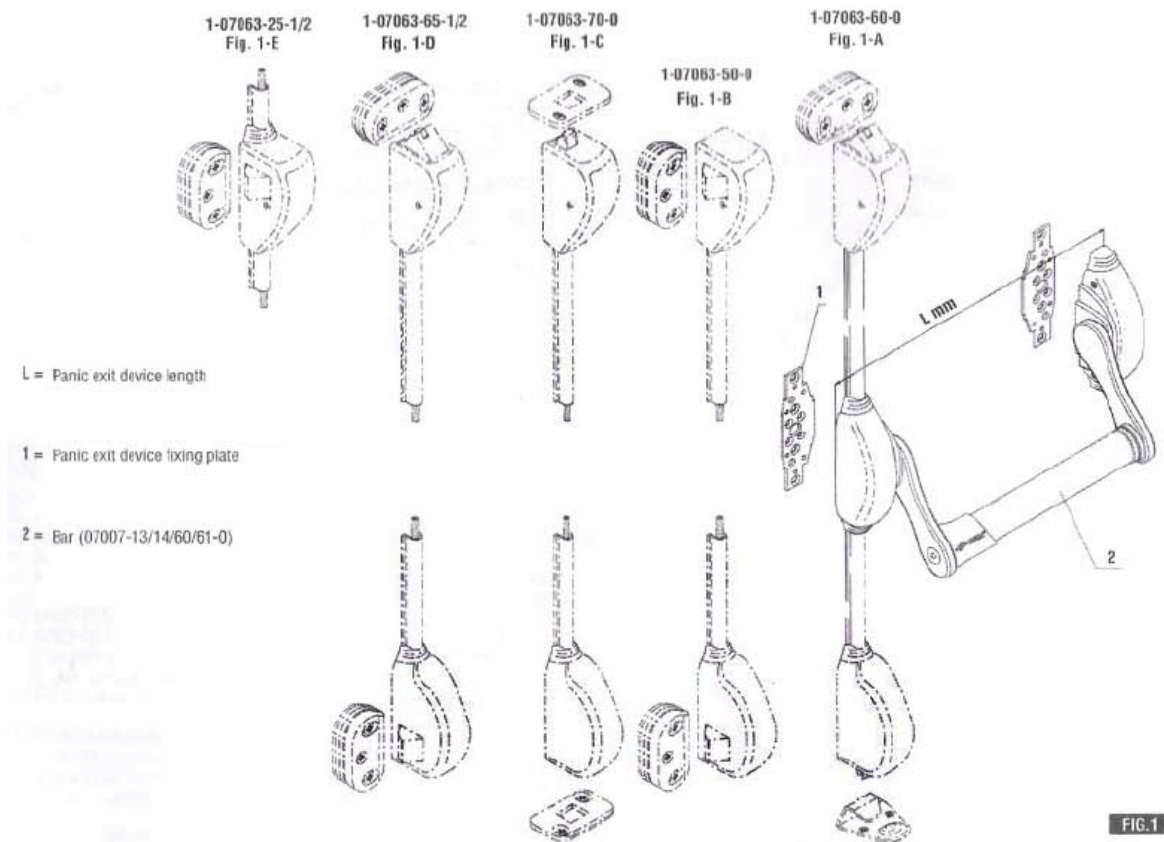

SINGLE DOORS

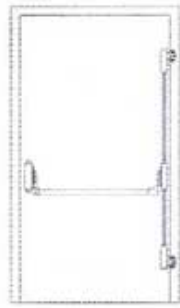

59015
07063-50-0



59015
07063-65-1/2

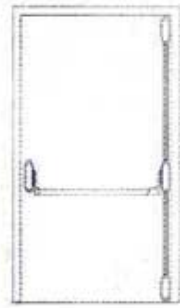

59015
07063-60-0

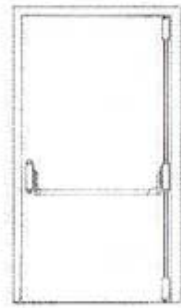

59015
07063-70-0

DOUBLE DOORS

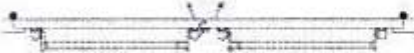
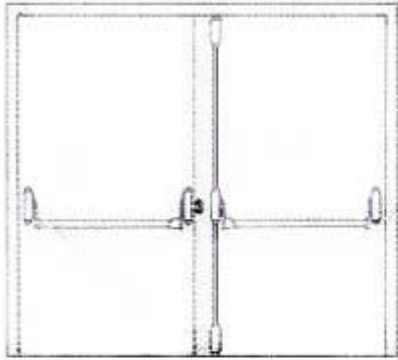

59010/
59000 + 59015
07063-60-0

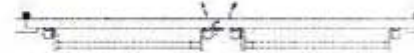
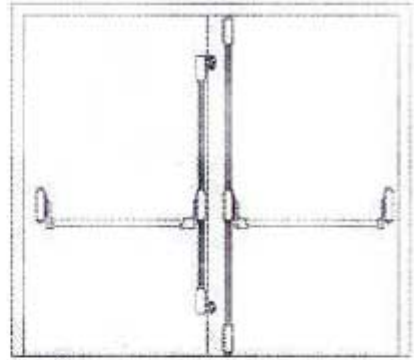

59015 + 59015
07063-50-0 + 07063-60-0

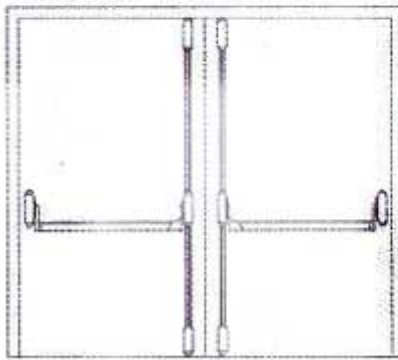

59015 + 59015
07063-60-0 + 07063-60-0

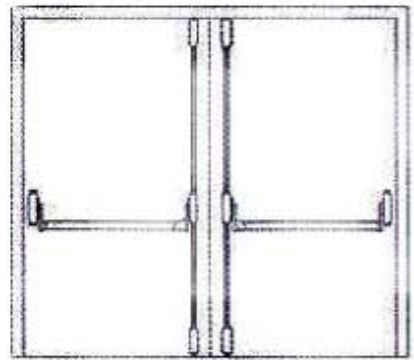

59015 + 59015
07063-70-0 + 07063-70-0

FIG. 2



07077-29-0



07077-28-0



07077-37-0

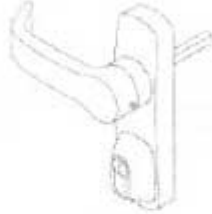

07077-38-0



07077-39-0

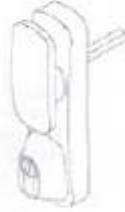

07077-40-0



06195-06-0



07065-51-0

OUTSIDE OPERATION DEVICES (To be ordered separately) (Fig. 2):

Item 07077-29-0 Plate and shaped cylinder item 02649-11, complete with 3 keys.

Item 07077-28-0 Plate and shaped cylinder item 02649-10 complete with 3 keys and a key-operated handle.

Item 07077-37-0 Plate with handle,

Item 07077-38-0 Plate with handle and shaped cylinder, item 08330-02 complete with 3 keys. When closed, the handle is idle.

Item 07077-39-0 Plate and shaped cylinder, item 08330-02 complete with 3 keys.

Item 07077-40-0 Plate with handle and shaped cylinder item 08330-02 complete with 3 keys. When closed, the handle is idle.

NOTE: For the assembly instructions of the items 07077-28/29/37/38/39/40, see the instruction sheet supplied with the outside operation devices.

OPTIONS (Fig. 2):

Item 06195-06-0 Microswitch kit.

Item 07065-51-0 Hold open device (not to be fitted to panic exit devices for fire doors).

PREPARATION

- 1) Check that the door is in good conditions and perfectly flat. With the door closed, draw a horizontal line G-D at 900 mm from the finished floor (Fig. 2).
- 2) Fix the templates to the door with adhesives (Fig. 3).

TEMPLATE A: main casing side.

CAUTION: TEMPLATE A to be positioned on the opening side according to the type of doorstop (Fig.4A and Fig.4B). For the correct position of the template with lateral latch-bolts (item 07063-50-0 and 07063-65-112) refer to Fig.4C and 40.

TEMPLATE B: secondary casing side. To be positioned on the hinge side.

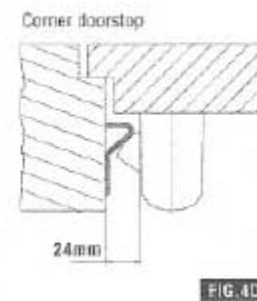
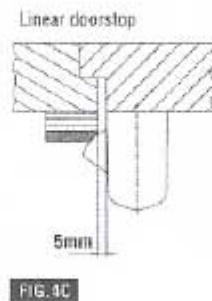
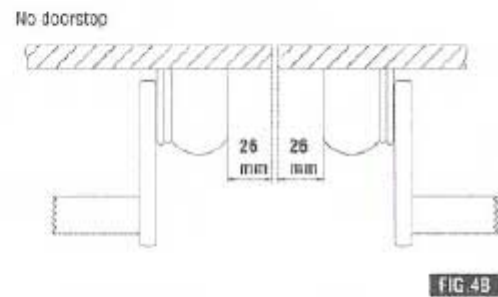
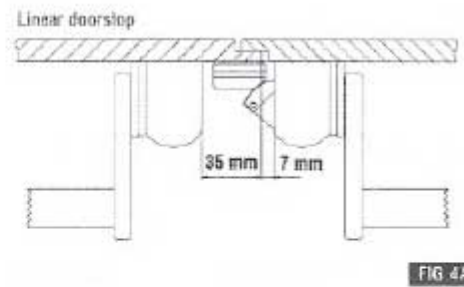
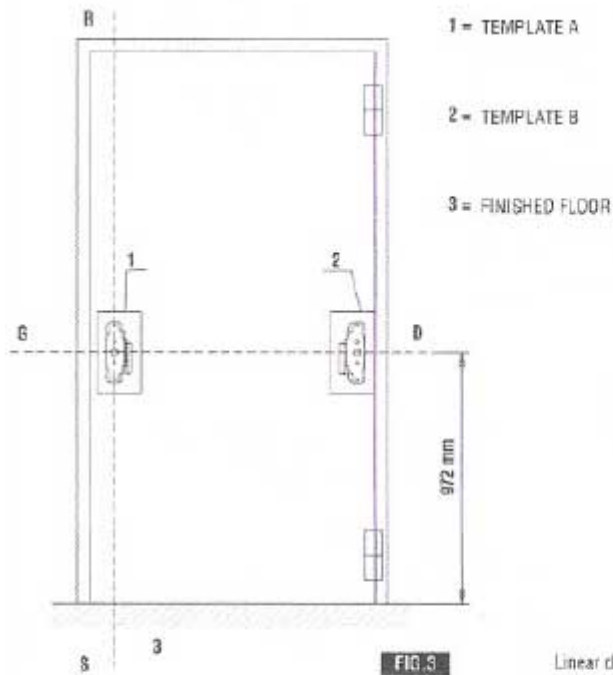

INSTALATION:

3) Use an awl to mark the position of the holes to be drilled (refer to the templates on the door). Drill the holes (approximate diameters for the aluminum profiles given below):

A) PANIC EXIT DEVICE WITHOUT OUTSIDE OPERATION DEVICE:

- H1-H2 = 03.5 mm (8 holes: 4 for main casing plate-spacer+ 4 for secondary casing , plate-space (Fig.5).

'B) PANIC EXIT DEVICE WITH OUTSIDE OPERATION DEVICE: - For the outside operation device fixing holes, refer to the instruction sheet supplied , with the items.

MAINCASING:

H1 = 2 holes 0 3.5 (for **plate-spacer**).

H2 = 2 throughholes 0 6mm (for the **plate-spacer and the outside operation device**)

H4 = 1 hole 0 15mm (for the panic exit device follower fig.1) - 0 11 (for the outside operation device handle square spindle, together with items 07077-28/29/37/38/ 39/40-0).

SECONDARY CASING:

- H1-H2 = 0 3.5 (for **plate-spacer**).

4) - Remove the templates.

- Fit the two **plate-spacer** onto the door by using the screws supplied, and then measure the "**X value**" in between the two plates (Fig. 5).

N.B. This distance will be used for cutting to measure the oval shaped bar.

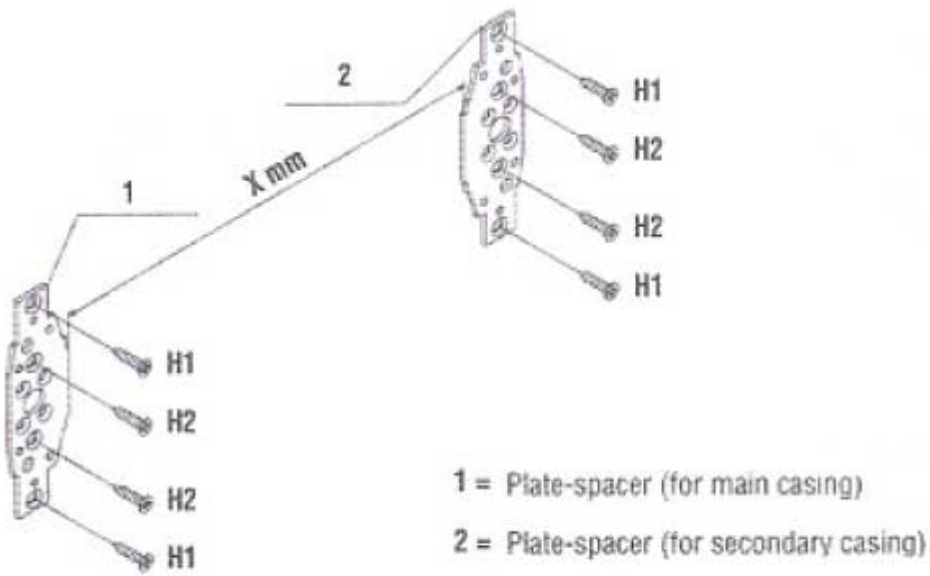

FIG.5

5) When present fit the outside operation device onto the main casing plate-spacer, by tightening the screws supplied with the outside operation device, to the holes H2.

6) Extract the case of both the main and the secondary casing (fig. 6).

7) Insert the outside operation device follower (if any), between the plate-space and the main casing (Fig. 1).

WARNING: Set the fitting end of the follower in correspondence of the reference marks on the fixing plate (Fig. 7A and 7B).

8) Fit the rod end in the main casing by keeping the panic exit device stirrup pressed down (Fig. 8).

9) Secure the main casing by using the two oval-headed screws for the outer holes and the two cheese-headed screws for the inner holes (fig. 9). If a reinforced installation (for light aluminium profiles for example), and improved anchoring of the panic exit device to the door are necessary, it is advisable to use self-drilling screws 4.2 x t9 10m (not supplied as standard) instead of cheese-headed screws M4 x 5 (Fig. 9A).

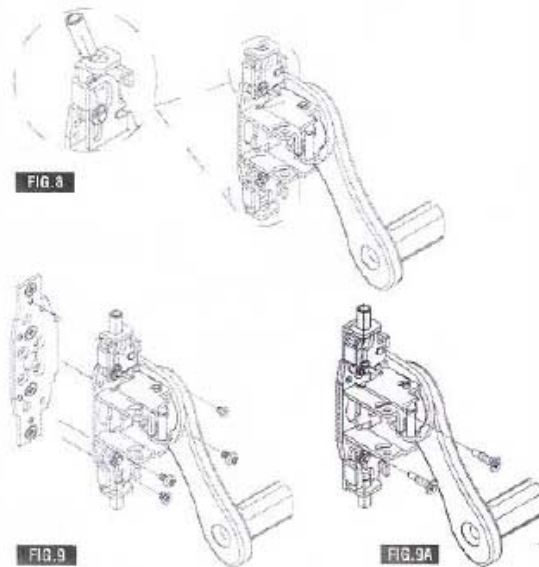
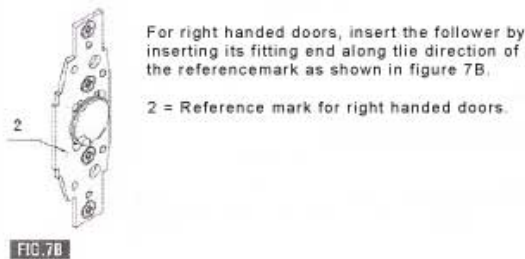
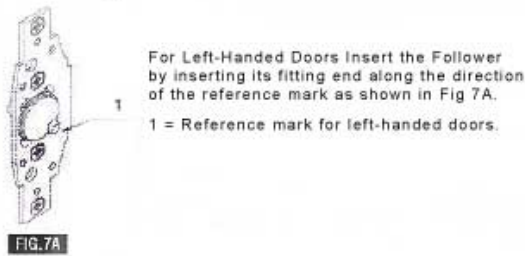
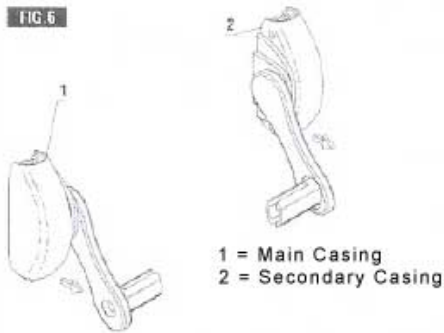

10) How to determine the panic exit device "hand":

- Position the secondary casing onto its plate-spacer, which should already be installed on the door, by manually placing it close to the plate and inserting it on the two reference pins until it fits perfectly.
- When the stirrup position is as shown in figure IDA, reposition it following the instructions below:

A) Slightly press down the stirrup and shift its stop pin by acting on the spring ring (fig. 10A).

B) rotate the stirrup until it is in the correct position for being used on an opposite hand door, then release the pin that will automatically reset (fig. 10B).

11) Cutting the bar.

- Cut the bar to **X = 25 mm** (Fig. 5).
- Fit on the bar the two connection plugs of the main and of the secondary stirrup (fig. 11) having them slide until in position.

12) Introduce the expansion nut and the M8 screw supplied, in the recesses obtained on the main and the secondary stirrups (fig. 12).

13) Position the bar on the main casing lever, insert the secondary casing lever from the opposite side, then secure the secondary casing with the four screws supplied (fig. 13). If a reinforced installation and improved anchoring on the panic exit device of the door are necessary, it is advisable to use self drilling screws 4.2 x 19 mm (not supplied as standard) instead of the cheese-headed screws M4 x 5. (Fig.13A).

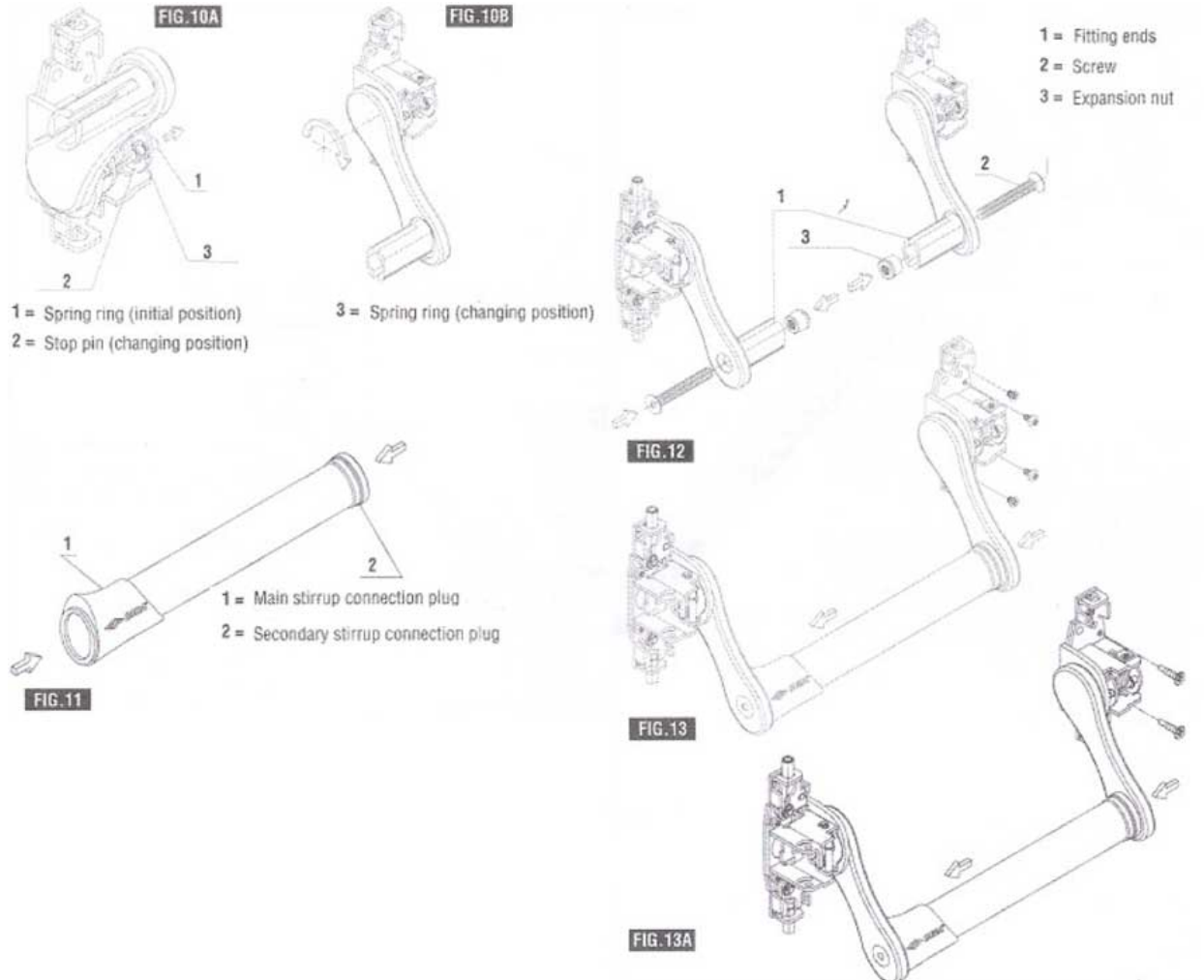

14) Check that the two connection plugs are in contact with the relevant stirrups block the bar with the Allen wrench (50101)(fig.14)then check that it returns to its initial position after being pressed.

15) Fit the additional locking device which has been chosen. Following the relevant instructions.

16) Fit the cases with the upper and lower plugs supplied with the product (fig. 15).

FINAL ASSEMBLY CHECK

Check the correct operation of the panic exit device:

A) Bar:

- After being pressed. it should automatically return to its initial position.
- When pressed from the secondary casing side (hinge side). the latch-bolt should withdraw all the way in -just as if it were pushed from the main casing side (leaf side).

B) ANTI-PICKING DEVICE: with the door closed, the latch-bolts must be firmly engaged (if manually actuated they should not withdraw), they should only move back if the bar or the outside operation device - if any – are actuated.

C) Grease the matching area in the panic exit device locking points between the latch-bolt and the striker with mineral grease having a working temperature suitable for the current conditions of use.

